

**LESSON** **Practice B**  
**7-2** **Ratios in Similar Polygons**

Identify the pairs of congruent corresponding angles and the corresponding sides.

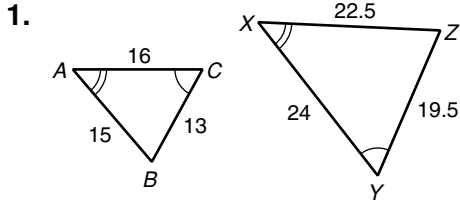

\_\_\_\_\_

\_\_\_\_\_

\_\_\_\_\_

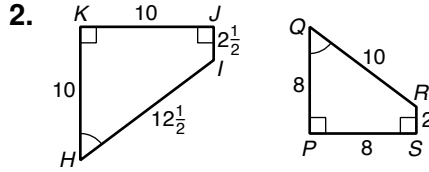

\_\_\_\_\_

\_\_\_\_\_

\_\_\_\_\_

Determine whether the polygons are similar. If so, write the similarity ratio and a similarity statement. If not, explain why not.

3. parallelograms *EFGH* and *TUVW*

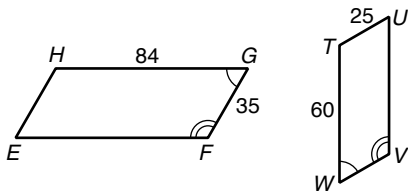

\_\_\_\_\_

\_\_\_\_\_

4.  $\triangle CDE$  and  $\triangle LMN$

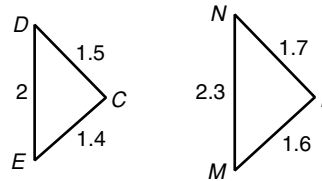

\_\_\_\_\_

\_\_\_\_\_

Tell whether the polygons must be similar based on the information given in the figures.

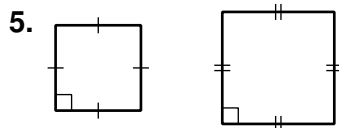

\_\_\_\_\_

\_\_\_\_\_

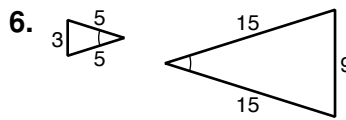

\_\_\_\_\_

\_\_\_\_\_

